

STAINLESS STEEL 316L PRESS FIT FITTINGS (M PROFILE)

COMPLY WITH BSEN1254-2: 1998

REDUCING CROSS TEE MXF



A Product of the nPressGuard® Solution

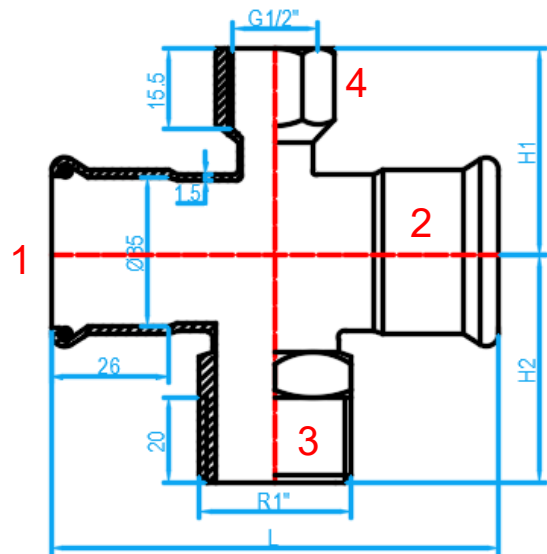

CROSS SECTIONAL VIEW

STANDARD SPECIFICATION

Working Pressure	16 Bar
Working Temperature	0 ~ 85°C
Applications	Hot and cold potable water system.

DIMENSIONS

STOCK CODE	SIZE (mm x mm x inch x inch)	L (mm)	H1 (mm)	H2 (mm)	WEIGHT (kg)	PCS/CTN
SS316LPFNCT3525M15F*	35X35X1"BSPTX1/2" BSP	100	43	54	0.241	30

*This item requires special ordering. Please consult with a salesperson for the estimated lead time.